

Overhead Shower - Square Build-in

---

# INSTALLATION GUIDE BOOK

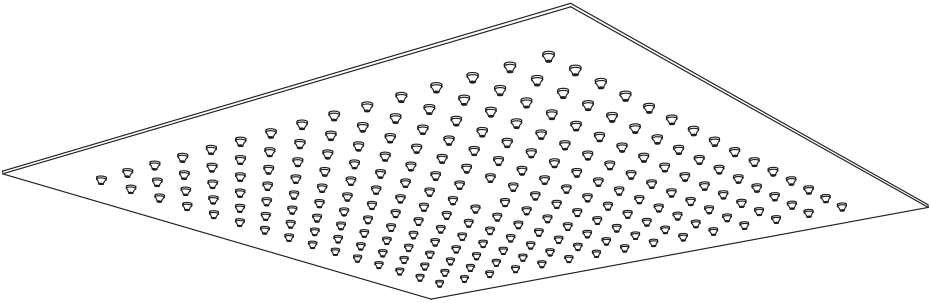

• THANK YOU FOR USING •

We have purpose to provide a better life inspired by clean, hygienic and healthy lifestyles. We created design of every products with creativity but contain with comfortable and balance as a way of living. And we gladly say Thank You for believing us.

• CARE AND CLEANING •

The products is designed of years of trouble free performance. By cleaning it periodically with mild soap, rinse thoroughly with warm water, and dry with a clean, soft cloth. It make your products keep looking new. To avoid dull the finish, do not use abrasive cleaners, steel wool or harsh chemicals. Failure to follow these intructions may void your warrant.

• CAUTION •

For safe operation of the product, please observe the following :

\* Operating pressure :

Minimum Pressure .... 1 bar (Flowing Pressure)  
Maximum Pressure .... 6 bar (Flowing Pressure)

\* Hot water supply temperature must not extend 80°C

\* Do not use steam for hot water supply

\* Do not use the product at ambient temperature below 0°C

• TOOLS YOU WILL NEED •



Wrench



Drill

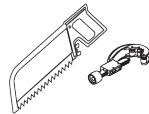

Saw

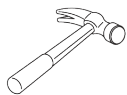

Hammer



Pencil

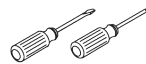

Screwdriver

• BEFORE YOU START INSTALLATION •

OBSERVE ALL LOCAL PLUMBING CODES

- \* Make sure water supply is shut off.
- \* Read these instructions carefully to ensure proper installation.
- \* Our product reserves the right to update product design without notice.
- \* Check to make sure you have the following parts indicated below.

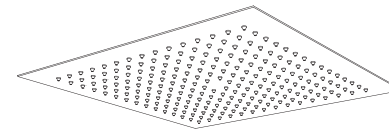

Shower Head

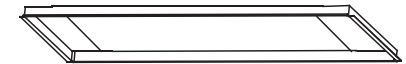

Bracket



Filter  
1x



Stud Bolt  
4x

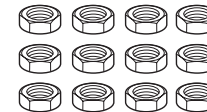

Nut  
12x



Wire  
4x



Strong Anchor Bolt  
4x

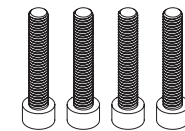

Bolt  
4x

**INFORMATION**

|        |                |              |              |              |
|--------|----------------|--------------|--------------|--------------|
| CODE   | SB380.002.CR   | SB430.002.CR | SB500.002.CR | SB600.002.CR |
| SIZE   | 380 x 380 mm   | 430 x 430 mm | 500 x 500 mm | 600 x 600 mm |
| FINISH | Chrome Plating |              |              |              |

**FLOW RATE**

| Water Pressure | (L/min) |     |     |     |
|----------------|---------|-----|-----|-----|
|                | 380     | 430 | 500 | 600 |
| 1 Bar          | 11      | 14  | 12  | 13  |
| 2 Bar          | 16      | 19  | 19  | 18  |
| 3 Bar          | 20      | 23  | 24  | 22  |
| 4 Bar          | 24      | 26  | 24  | 24  |

\*Direct Connection Without Tap

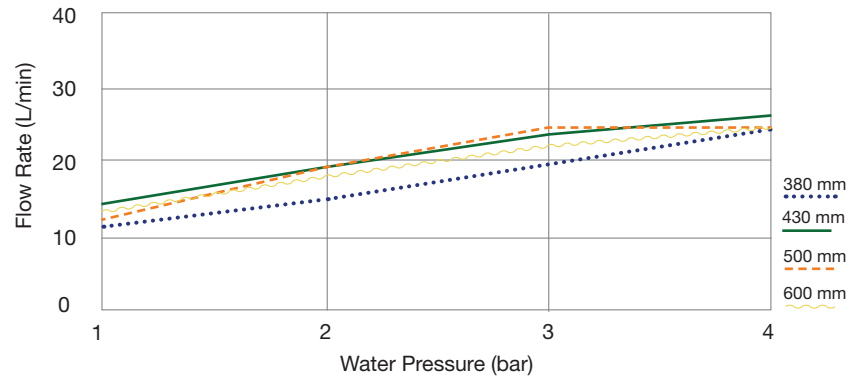

**DIMENSION**

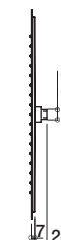
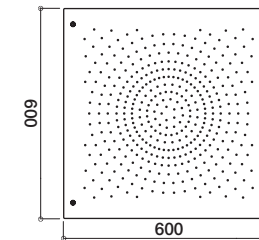
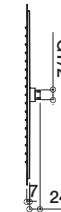
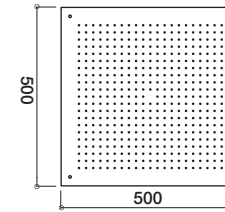
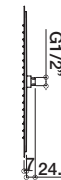
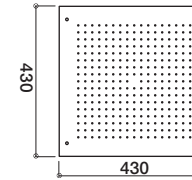
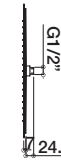
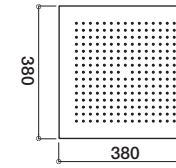

Front

Side

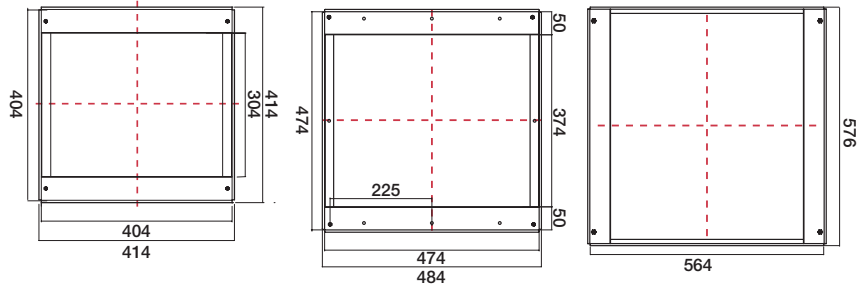
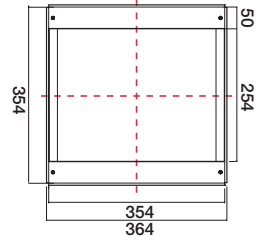
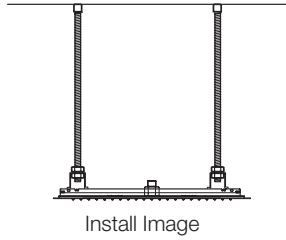

Bracket Size

INSTALLATION PROCEDURE

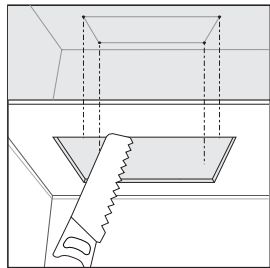

1. Cut the ceiling to install the bracket and mark 4 positions on the upper ceiling for anchor bolts.  
 SB380.002.CR : 355 x 355 mm  
 SB430.002.CR : 405 x 405 mm  
 SB500.002.CR : 475 x 475 mm  
 SB600.002.CR : 570 x 570 mm \*(Error range ±10mm)

2. Make the 4 holes (Ø12 mm) on the 4 marks. Put the 4 strong anchors to holes and hit them with a hammer.  
 SB380.002.CR : 305 x 300 mm  
 SB430.002.CR : 350 x 358 mm  
 SB500.002.CR : 420 x 420 mm  
 SB600.002.CR : 500 x 500 mm

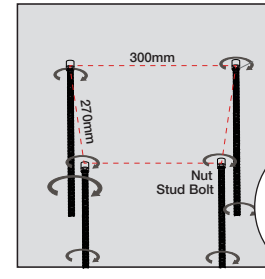
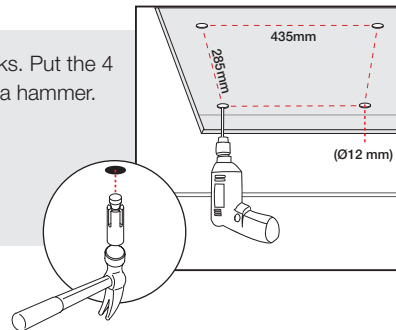

3. Screw 4 stud bolts (M6x1.0P) to the anchor bolts and fasten each bolt with a nut.

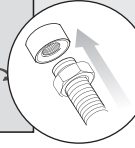

4. Check the length between the upper ceiling and built-in bracket.  
 Cut the stud bolts according to the measured value.  
 Put one nut to each stud bolt.  
 It must be 20mm gap between stub bolt and ceiling.

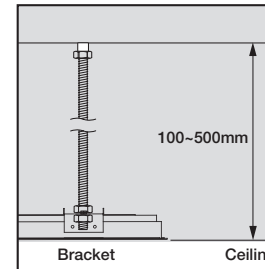
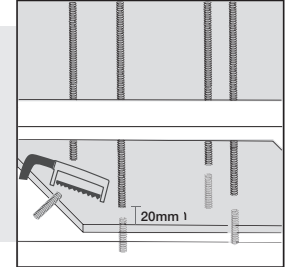

5. Put the bracket to the ceiling.

6. Tighten the stud nuts with 4 nuts and adjust the height.

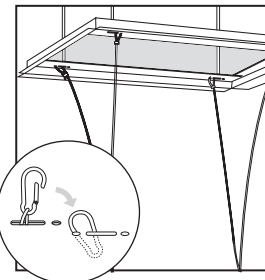
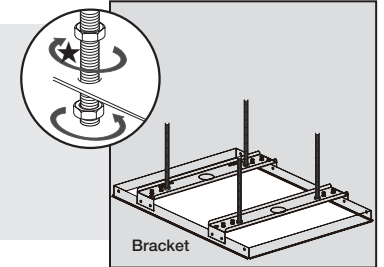

7. Hang wires of the head on the bracket.

8. Connect water supply hoses to the shower head.

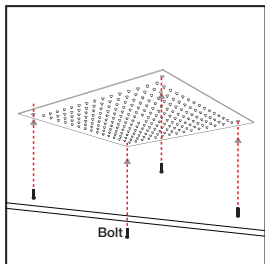
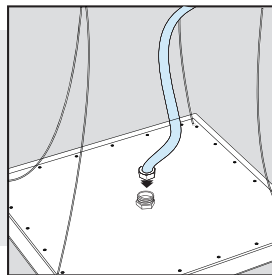

9. Put the shower head to the bracket.  
Fix the head with 4 bolts.